



LCWD
Lebec County Water District

PACKET

March 8, 2022

FOR PUBLIC VIEW ONLY

(Please do not remove from office)

8:46 AM
03/03/22

LEBEC COUNTY WATER DISTRICT
Reconciliation Summary
1040 - Grant Checking Account, Period Ending 02/28/2022

| | <u>Feb 28, 22</u> |
|-----------------------------------|-------------------|
| Beginning Balance | 25.25 |
| Cleared Balance | 25.25 |
| Register Balance as of 02/28/2022 | 25.25 |
| Ending Balance | 25.25 |

8:46 AM

03/03/22

LEBEC COUNTY WATER DISTRICT

Reconciliation Detail

1040 - Grant Checking Account, Period Ending 02/28/2022

| Type | Date | Num | Name | Clr | Amount | Balance |
|-----------------------------------|------|-----|------|-----|--------|--------------|
| Beginning Balance | | | | | | 25.25 |
| Cleared Balance | | | | | | 25.25 |
| Register Balance as of 02/28/2022 | | | | | | 25.25 |
| Ending Balance | | | | | | <u>25.25</u> |

9:36 AM

03/03/22

LEBEC COUNTY WATER DISTRICT
Reconciliation Summary
1020 · Lebec Co Water Dist. - Checking, Period Ending 02/28/2022

| | <u>Feb 28, 22</u> |
|--|-------------------------|
| Beginning Balance | 83,858.34 |
| Cleared Transactions | |
| Checks and Payments - 51 ite... | -46,027.12 |
| Deposits and Credits - 34 items | 48,115.26 |
| Total Cleared Transactions | <u>2,088.14</u> |
| Cleared Balance | <u><u>85,946.48</u></u> |
| Uncleared Transactions | |
| Checks and Payments - 8 items | -3,019.99 |
| Deposits and Credits - 1 item | 172.04 |
| Total Uncleared Transactions | <u>-2,847.95</u> |
| Register Balance as of 02/28/2022 | <u><u>83,098.53</u></u> |
| Ending Balance | 83,098.53 |

LEBEC COUNTY WATER DISTRICT

Reconciliation Detail

1020 · Lebec Co Water Dist. - Checking, Period Ending 02/28/2022

| Type | Date | Num | Name | Clr | Amount | Balance |
|---------------------------------------|------------|---------|-----------------------|-----|-------------------|-------------------|
| Beginning Balance | | | | | | 83,858.34 |
| Cleared Transactions | | | | | | |
| Checks and Payments - 51 items | | | | | | |
| Bill Pmt -Check | 12/20/2021 | 10431 | Benjamin, Ronald | X | -100.00 | -100.00 |
| Bill Pmt -Check | 01/24/2022 | 10477 | PGE5159 | X | -2,373.38 | -2,473.38 |
| Bill Pmt -Check | 01/24/2022 | 10479 | PGE8279 | X | -1,903.57 | -4,376.95 |
| Bill Pmt -Check | 01/24/2022 | 10484 | Wainright Emilie | X | -1,000.00 | -5,376.95 |
| Bill Pmt -Check | 01/24/2022 | 10480 | Pitney Bowes Pur... | X | -171.96 | -5,548.91 |
| Bill Pmt -Check | 01/24/2022 | 10476 | PGE4923 | X | -28.62 | -5,577.53 |
| Bill Pmt -Check | 01/24/2022 | 10478 | PGE5230 | X | -25.47 | -5,603.00 |
| Check | 01/31/2022 | 10486 | AFLAC | X | -175.08 | -5,778.08 |
| Bill Pmt -Check | 02/03/2022 | 10491 | Brown Armstrong... | X | -3,800.00 | -9,578.08 |
| Bill Pmt -Check | 02/03/2022 | 10492 | Ca Bank-Visa | X | -1,849.38 | -11,427.46 |
| Bill Pmt -Check | 02/03/2022 | 10493 | Core & Main | X | -1,032.68 | -12,460.14 |
| Bill Pmt -Check | 02/03/2022 | 10498 | XiO | X | -858.00 | -13,318.14 |
| Bill Pmt -Check | 02/03/2022 | 10500 | State Compensat... | X | -588.25 | -13,906.39 |
| Bill Pmt -Check | 02/03/2022 | 10499 | Lewis & Associates | X | -570.00 | -14,476.39 |
| Bill Pmt -Check | 02/03/2022 | 10495 | Mountain Auto B... | X | -510.00 | -14,986.39 |
| Bill Pmt -Check | 02/03/2022 | 10489 | Amber Chemical ... | X | -222.42 | -15,208.81 |
| Bill Pmt -Check | 02/03/2022 | 10490 | At&T Office | X | -220.50 | -15,429.31 |
| Bill Pmt -Check | 02/03/2022 | 10494 | Janitorial USA | X | -200.00 | -15,629.31 |
| Bill Pmt -Check | 02/03/2022 | 10487 | 3D Imaging Syste... | X | -132.18 | -15,761.49 |
| Bill Pmt -Check | 02/03/2022 | 10497 | Verizon Wireless | X | -131.92 | -15,893.41 |
| Bill Pmt -Check | 02/03/2022 | 10496 | Price Disposal | X | -75.52 | -15,968.93 |
| Bill Pmt -Check | 02/03/2022 | 10488 | Ability Answering ... | X | -62.50 | -16,031.43 |
| Paycheck | 02/07/2022 | 10502 | Jessica Carroll | X | -2,355.83 | -18,387.26 |
| Liability Check | 02/07/2022 | E-pay | EFTPS | X | -1,849.82 | -20,237.08 |
| Paycheck | 02/07/2022 | 10503 | William Adame | X | -1,819.69 | -22,056.77 |
| Paycheck | 02/07/2022 | 10501 | Daniel F Garcia | X | -1,763.37 | -23,820.14 |
| Liability Check | 02/07/2022 | E-pay | EDD | X | -277.14 | -24,097.28 |
| Bill Pmt -Check | 02/14/2022 | 10508 | Puckett, Rick | X | -200.00 | -24,297.28 |
| Bill Pmt -Check | 02/14/2022 | 10506 | Guadarrama,Chris | X | -200.00 | -24,497.28 |
| Bill Pmt -Check | 02/14/2022 | 10505 | Benjamin, Ronald | X | -100.00 | -24,597.28 |
| Bill Pmt -Check | 02/18/2022 | 10517 | PGE5159 | X | -2,534.46 | -27,131.74 |
| Paycheck | 02/18/2022 | 10510 | Jessica Carroll | X | -2,355.81 | -29,487.55 |
| Paycheck | 02/18/2022 | 10511 | William Adame | X | -1,818.79 | -31,306.34 |
| Liability Check | 02/18/2022 | E-pay | EFTPS | X | -1,778.42 | -33,084.76 |
| Paycheck | 02/18/2022 | 10509 | Daniel F Garcia | X | -1,647.90 | -34,732.66 |
| Bill Pmt -Check | 02/18/2022 | 10515 | Hometown Publis... | X | -1,163.25 | -35,895.91 |
| Bill Pmt -Check | 02/18/2022 | 10521 | SCE-PUMP PO... | X | -922.83 | -36,818.74 |
| Bill Pmt -Check | 02/18/2022 | 10523 | Walter Mortensen... | X | -833.00 | -37,651.74 |
| Liability Check | 02/18/2022 | E-pay | EDD | X | -258.18 | -37,909.92 |
| Bill Pmt -Check | 02/18/2022 | 10512 | Anthem Blue Cross | X | -167.52 | -38,077.44 |
| Bill Pmt -Check | 02/18/2022 | 10514 | Gas Company | X | -166.36 | -38,243.80 |
| Bill Pmt -Check | 02/18/2022 | 10524 | Wells Fargo Bank | X | -96.53 | -38,340.33 |
| Bill Pmt -Check | 02/18/2022 | 10513 | AT&T Uverse | X | -83.15 | -38,423.48 |
| Bill Pmt -Check | 02/18/2022 | 10520 | SCE-OFFICE | X | -48.65 | -38,472.13 |
| Bill Pmt -Check | 02/18/2022 | 10519 | Pitney Bowes/Re... | X | -32.07 | -38,504.20 |
| Bill Pmt -Check | 02/18/2022 | 10516 | PGE4923 | X | -27.10 | -38,531.30 |
| Bill Pmt -Check | 02/18/2022 | 10518 | PGE5230 | X | -22.99 | -38,554.29 |
| Check | 02/22/2022 | | Covered Ca | X | -2,456.18 | -41,010.47 |
| Check | 02/28/2022 | 0009... | Fraud | X | -4,950.65 | -45,961.12 |
| Check | 02/28/2022 | | Ca Bank & Trust | X | -60.00 | -46,021.12 |
| Check | 02/28/2022 | | QuickBooks Payr... | X | -6.00 | -46,027.12 |
| Total Checks and Payments | | | | | -46,027.12 | -46,027.12 |

LEBEC COUNTY WATER DISTRICT

Reconciliation Detail

1020 · Lebec Co Water Dist. - Checking, Period Ending 02/28/2022

| Type | Date | Num | Name | Clr | Amount | Balance |
|--|------------|-------|-----------------------|-----|----------------|------------------|
| Deposits and Credits - 34 items | | | | | | |
| Deposit | 02/10/2022 | | | X | 35.93 | 35.93 |
| Deposit | 02/10/2022 | | | X | 95.51 | 131.44 |
| Deposit | 02/10/2022 | | | X | 120.00 | 251.44 |
| Deposit | 02/10/2022 | | | X | 146.71 | 398.15 |
| Deposit | 02/10/2022 | | | X | 200.00 | 598.15 |
| Deposit | 02/10/2022 | | | X | 248.55 | 846.70 |
| Deposit | 02/10/2022 | | | X | 555.05 | 1,401.75 |
| Deposit | 02/10/2022 | | | X | 611.27 | 2,013.02 |
| Deposit | 02/10/2022 | | | X | 1,000.00 | 3,013.02 |
| Deposit | 02/10/2022 | | | X | 6,461.11 | 9,474.13 |
| Deposit | 02/16/2022 | | | X | 40.01 | 9,514.14 |
| Deposit | 02/16/2022 | | | X | 40.01 | 9,554.15 |
| Deposit | 02/16/2022 | | | X | 57.00 | 9,611.15 |
| Deposit | 02/16/2022 | | | X | 113.41 | 9,724.56 |
| Deposit | 02/16/2022 | | | X | 120.00 | 9,844.56 |
| Deposit | 02/16/2022 | | | X | 230.02 | 10,074.58 |
| Deposit | 02/16/2022 | | | X | 14,604.89 | 24,679.47 |
| Deposit | 02/18/2022 | | | X | 3,595.37 | 28,274.84 |
| Deposit | 02/22/2022 | | | X | 60.00 | 28,334.84 |
| Deposit | 02/22/2022 | | | X | 2,330.88 | 30,665.72 |
| Check | 02/28/2022 | 10504 | Void | X | 0.00 | 30,665.72 |
| Deposit | 02/28/2022 | | | X | 22.03 | 30,687.75 |
| Deposit | 02/28/2022 | | | X | 40.01 | 30,727.76 |
| Deposit | 02/28/2022 | | | X | 42.49 | 30,770.25 |
| Deposit | 02/28/2022 | | | X | 44.96 | 30,815.21 |
| Deposit | 02/28/2022 | | | X | 46.17 | 30,861.38 |
| Deposit | 02/28/2022 | | | X | 80.00 | 30,941.38 |
| Deposit | 02/28/2022 | | | X | 127.37 | 31,068.75 |
| Deposit | 02/28/2022 | | | X | 161.11 | 31,229.86 |
| Deposit | 02/28/2022 | | | X | 332.00 | 31,561.86 |
| Deposit | 02/28/2022 | | | X | 695.12 | 32,256.98 |
| Deposit | 02/28/2022 | | | X | 1,744.35 | 34,001.33 |
| Deposit | 02/28/2022 | | | X | 4,950.65 | 38,951.98 |
| Deposit | 02/28/2022 | | | X | 9,163.28 | 48,115.26 |
| Total Deposits and Credits | | | | | 48,115.26 | 48,115.26 |
| Total Cleared Transactions | | | | | 2,088.14 | 2,088.14 |
| Cleared Balance | | | | | 2,088.14 | 85,946.48 |
| Uncleared Transactions | | | | | | |
| Checks and Payments - 8 items | | | | | | |
| Bill Pmt -Check | 02/14/2022 | 10507 | Nic Wenderoth | | -200.00 | -200.00 |
| Bill Pmt -Check | 02/18/2022 | 10522 | Wainright Emilie | | -1,000.00 | -1,200.00 |
| Bill Pmt -Check | 02/28/2022 | 10528 | Ca Bank-Visa | | -1,219.42 | -2,419.42 |
| Bill Pmt -Check | 02/28/2022 | 10527 | Amber Chemical ... | | -237.24 | -2,656.66 |
| Bill Pmt -Check | 02/28/2022 | 10529 | Verizon Wireless | | -131.96 | -2,788.62 |
| Bill Pmt -Check | 02/28/2022 | 10530 | Zalco Laboratories | | -125.00 | -2,913.62 |
| Bill Pmt -Check | 02/28/2022 | 10525 | Ability Answering ... | | -77.62 | -2,991.24 |
| Bill Pmt -Check | 02/28/2022 | 10526 | Advanced Data S... | | -28.75 | -3,019.99 |
| Total Checks and Payments | | | | | -3,019.99 | -3,019.99 |
| Deposits and Credits - 1 item | | | | | | |
| Deposit | 02/28/2022 | | | | 172.04 | 172.04 |
| Total Deposits and Credits | | | | | 172.04 | 172.04 |
| Total Uncleared Transactions | | | | | -2,847.95 | -2,847.95 |
| Register Balance as of 02/28/2022 | | | | | -759.81 | 83,098.53 |
| Ending Balance | | | | | -759.81 | 83,098.53 |

LEBEC COUNTY WATER DISTRICT

Profit & Loss YTD Comparison

03/03/22

Accrual Basis

February 2022

| | Feb 22 | Jul '21 - Feb 22 |
|---|------------------|-------------------|
| Ordinary Income/Expense | | |
| Income | | |
| 4000 · Operating Revenue | | |
| 4010 · Commercial | 12,611.20 | 133,964.48 |
| 4040 · Residential | 13,478.88 | 127,726.96 |
| 4100 · Kern Co Tax Income | 1,250.17 | 32,080.70 |
| 4120 · Surplus Water | 2,756.25 | 38,287.34 |
| 4130 · Will Serve | 77.14 | 661.20 |
| 4140 · Late Charges & Customer Charg... | 1,546.51 | 8,620.90 |
| Total 4000 · Operating Revenue | 31,720.15 | 341,341.58 |
| Total Income | 31,720.15 | 341,341.58 |
| Expense | | |
| 6020 · Auto Expense | | |
| 6022 · Gas | 523.77 | 8,330.89 |
| 6028 · Repairs | | |
| 6028.1 · Chevy | 127.83 | 226.56 |
| 6028.2 · DODGE | 0.00 | 1,556.61 |
| 6028.4 · GENERATOR | 0.00 | 4,716.86 |
| Total 6028 · Repairs | 127.83 | 6,500.03 |
| 6030 · Service | | |
| 6030.1 · Dodge Service | 0.00 | 358.99 |
| 6030.2 · Chevy Service | 0.00 | 671.23 |
| Total 6030 · Service | 0.00 | 1,030.22 |
| Total 6020 · Auto Expense | 651.60 | 15,861.14 |
| 6040 · Bank Service Charge | 48.83 | 478.25 |
| 6050 · Compensation of Board | 500.00 | 2,600.00 |
| 6051 · GSA Compensation of Board | 200.00 | 900.00 |
| 6060 · Contracted Maintenance Services | 0.00 | 3,385.20 |
| 6065 · Depreciation | 5,076.67 | 40,613.36 |
| 6070 · Dues & Subscriptions | 75.00 | 4,257.00 |
| 6075 · Education | 0.00 | 260.00 |
| 6081 · Emergency Communications | 44.72 | 356.64 |
| 6090 · Equipment Rental | 128.60 | 1,001.02 |
| 6095 · Fees and Permits | 0.00 | 1,029.34 |
| 6105 · Interest | 0.00 | 41.17 |
| 6110 · Insurance | | |
| 6112 · Insurance - AFLAC | 0.00 | 0.00 |
| 6113 · Medical Insurance | 2,623.70 | 21,709.68 |
| 6115 · Business Insurance | 1,737.08 | 7,950.19 |
| 6120 · Workers Compensation Insurance | 588.25 | 5,218.00 |
| Total 6110 · Insurance | 4,949.03 | 34,877.87 |
| 6130 · Maintenance | | |
| 6135 · Maintenance Services-System | 0.00 | 1,921.45 |
| 6140 · Maintenance Supplies | 237.24 | 5,245.41 |
| Total 6130 · Maintenance | 237.24 | 7,166.86 |

LEBEC COUNTY WATER DISTRICT

Profit & Loss YTD Comparison

03/03/22

Accrual Basis

February 2022

| | Feb 22 | Jul '21 - Feb 22 |
|--|------------------|-------------------|
| 6155 · Office Expense | | |
| 6160 · Computer | 0.00 | 220.00 |
| 6170 · Answering Service | 77.62 | 579.09 |
| 6175 · Office Repair | 110.37 | 2,104.77 |
| 6182 · Supplies-GSA | 1,163.25 | 1,163.25 |
| 6185 · Supplies | 102.37 | 1,924.16 |
| Total 6155 · Office Expense | 1,453.61 | 5,991.27 |
| 6190 · Operating Supplies | 460.65 | 460.65 |
| 6205 · Outside Services | 0.00 | 468.00 |
| 6215 · Payroll - Gross Wages | 15,255.03 | 116,869.99 |
| 6235 · Payroll Service Fees | 6.00 | 48.00 |
| 6245 · Postage | 0.00 | 1,627.56 |
| 6250 · Professional Fees | | |
| 6255 · Accounting / Bookkeeping | 570.00 | 4,200.00 |
| 6260 · Audit | 0.00 | 16,300.00 |
| Total 6250 · Professional Fees | 570.00 | 20,500.00 |
| 6290 · Rent | 1,000.00 | 8,000.00 |
| 6310 · Software System | 0.00 | 2,378.39 |
| 6315 · Taxes | | |
| 6320 · Payroll Taxes | 1,458.32 | 11,104.14 |
| 6325 · Property Tax | 0.00 | 115.15 |
| Total 6315 · Taxes | 1,458.32 | 11,219.29 |
| 6340 · Telephone | 215.11 | 3,239.41 |
| 6355 · Utilities - Office | | |
| 6360 · Electric | 48.65 | 659.24 |
| 6365 · Gas | 166.36 | 358.67 |
| 6370 · Trash | 0.00 | 414.66 |
| Total 6355 · Utilities - Office | 215.01 | 1,432.57 |
| 6375 · Utilities - Pumps | | |
| 6380 · Electric | 3,507.38 | 38,530.26 |
| Total 6375 · Utilities - Pumps | 3,507.38 | 38,530.26 |
| 6390 · Water Test | 125.00 | 1,487.50 |
| Total Expense | 36,177.80 | 325,080.74 |
| Net Ordinary Income | -4,457.65 | 16,260.84 |
| Other Income/Expense | | |
| Other Income | | |
| 9000 · Interest Income | 0.00 | 28.85 |
| 9010 · Gain/Loss on Asset | 0.00 | 1,000.00 |
| 9012 · Donations Revenue | 0.00 | 151,564.23 |
| Total Other Income | 0.00 | 152,593.08 |
| Net Other Income | 0.00 | 152,593.08 |

10:21 AM

03/03/22

Accrual Basis

LEBEC COUNTY WATER DISTRICT
Profit & Loss YTD Comparison

February 2022

| | <u>Feb 22</u> | <u>Jul '21 - Feb 22</u> |
|-------------------|------------------|-------------------------|
| Net Income | -4,457.65 | 168,853.92 |

LEBEC COUNTY WATER DISTRICT

03/03/22

Balance Sheet

Accrual Basis

As of February 28, 2022

| | Feb 28, 22 |
|---|-------------------|
| ASSETS | |
| Current Assets | |
| Checking/Savings | |
| 1011 - Customer Change Petty Ca | 300.00 |
| 1020 - Lebec Co Water Dist. - Checki... | 82,624.33 |
| 1040 - Grant Checking Account | 25.25 |
| 1080 - Savings | |
| 1081 - Emergency Fund Reserve | 120,000.00 |
| 1080 - Savings - Other | 445,484.59 |
| Total 1080 - Savings | 565,484.59 |
| Total Checking/Savings | 648,434.17 |
| Accounts Receivable | |
| 1200 - Accounts Receivable | 30,148.81 |
| Total Accounts Receivable | 30,148.81 |
| Other Current Assets | |
| 1260 - Bad Debt Loss A/R | -231.55 |
| 1350 - Prepaid Dues | 225.00 |
| 1360 - Prepaid Insurance | 4,520.44 |
| Total Other Current Assets | 4,513.89 |
| Total Current Assets | 683,096.87 |
| Fixed Assets | |
| 1400 - Fixed Assets | |
| 1410 - Land | 15,521.00 |
| 1415 - Used Generator | 35,749.80 |
| 1425 - C-Train Storage Unit | 4,440.15 |
| 1426 - Used C-Train Storage Unit | 4,688.91 |
| 1427 - Generators-3 New-Donated | 152,608.05 |
| 1430 - Office Equipment | 4,352.00 |
| 1435 - JW/Lebec Rd Mainline | 40,400.00 |
| 1440 - RVS Software | 2,800.00 |
| 1445 - State Well Pump & Motor | 20,221.16 |
| 1450 - 2011 Dodge Truck | 36,179.75 |
| 1455 - Chimney Canyon Valve | 2,851.82 |
| 1460 - 2012 Chevy Truck | 17,544.00 |
| 1465 - 2020 Chevy Truck | 34,000.00 |
| 1470 - Soft Start Well | 7,975.00 |
| 1475 - Chimney Canyon Pump | 1,294.35 |
| 1480 - Used Welder | 2,600.00 |
| 1485 - Lebec Well Chlorinator | 1,665.36 |
| 1495 - Generator | 8,225.00 |
| 1500 - Other Equipment | 8,250.00 |
| 1530 - Inventory | 36,205.90 |
| 1590 - Lebec Well Motor Pump | 10,109.35 |
| 1600 - Pumps & Wells | 195,710.49 |
| 1601 - Chimney Cyn Pump Motor | 10,982.70 |
| 1602 - Pump Equipment | 36,932.00 |
| 1610 - Tanks | 306,208.72 |
| 1615 - Tank Ladders | 6,972.00 |

LEBEC COUNTY WATER DISTRICT

03/03/22

Balance Sheet

Accrual Basis

As of February 28, 2022

| | Feb 28, 22 |
|---|---------------------|
| 1620 · Transmission & Distribution | 636,423.00 |
| 1630 · Tools | 2,220.94 |
| 1631 · Portable Pump | 1,864.00 |
| 1635 · Transfer Switches | 29,548.80 |
| 1640 · XiO System | 58,349.90 |
| 1643 · Lebec/North Drive Valves | 11,265.27 |
| 1645 · Clay Valves | 35,190.69 |
| 1690 · Accumulated Depreciation | -1,084,323.69 |
| Total 1400 · Fixed Assets | 695,026.42 |
| Total Fixed Assets | 695,026.42 |
| Other Assets | |
| 1800 · Deposits | 1,000.00 |
| Total Other Assets | 1,000.00 |
| TOTAL ASSETS | 1,379,123.29 |
| LIABILITIES & EQUITY | |
| Liabilities | |
| Current Liabilities | |
| Accounts Payable | |
| 2010 · Accounts Payable | 110.37 |
| Total Accounts Payable | 110.37 |
| Other Current Liabilities | |
| 2030 · Surplus Water Deposits | 16,000.00 |
| 2110 · Direct Deposit Liabilities | 288.24 |
| 2300 · Payroll Liabilities | |
| 2310 · Federal Withholding | -0.11 |
| 2320 · FICA | -0.45 |
| 2330 · State Withholding | 0.41 |
| 2350 · SUTA | 0.07 |
| 2360 · SDI | -0.14 |
| 2300 · Payroll Liabilities - Other | 1,354.03 |
| Total 2300 · Payroll Liabilities | 1,353.81 |
| Total Other Current Liabilities | 17,642.05 |
| Total Current Liabilities | 17,752.42 |
| Total Liabilities | 17,752.42 |
| Equity | |
| 3290 · Fund Balance -Net Assets | 797,919.12 |
| 3300 · Retained Earnings | 394,561.14 |
| 3310 · Prior Period Adjustment | 36.69 |
| Net Income | 168,853.92 |
| Total Equity | 1,361,370.87 |
| TOTAL LIABILITIES & EQUITY | 1,379,123.29 |

10:00 AM

03/03/22

LEBEC COUNTY WATER DISTRICT

A/P Aging Detail

As of March 3, 2022

| <u>Name</u> | <u>Memo</u> | <u>Open Balance</u> |
|-------------------------------|---|---------------------|
| Current | | |
| 3D Imaging Syste... | copier maint | 110.37 |
| Advanced Data St... | Shredding 6185 | 28.75 |
| Ability Answering ... | | 77.62 |
| Amber Chemical Inc | | 237.24 |
| Ca Bank-Visa | | 1,219.42 |
| Verizon Wireless | | 131.96 |
| Zalco Laboratories | | 125.00 |
| AT&T Uverse | | 83.15 |
| Anthem Blue Cross | 6113 medical insurance | 167.52 |
| Hometown Publis... | Legal Ad - GSA | 1,163.25 |
| PGE5159 | 6380 State Well Pump Electrici... | 2,534.46 |
| PGE4923 | 6380 Ridge Route Pump | 27.10 |
| PGE5230 | 6380 Landfill Rd Booster Electr... | 22.99 |
| Pitney Bowes/Ren... | | 32.07 |
| Gas Company | 6365 office 6365- Acct# 046016... | 166.36 |
| SCE-OFFICE | | 48.65 |
| SCE-PUMP POWER | | 922.83 |
| Wells Fargo Bank | | 96.53 |
| Walter Mortensen ... | 1360 annual payment | 833.00 |
| Wainright Emilie | | 1,000.00 |
| Nic Wenderoth | Regular meeting 02-8-2022 | 100.00 |
| Benjamin, Ronald | meeting 2-8-22 | 100.00 |
| Puckett, Rick | meeting 02-08-2022 | 100.00 |
| Guadarrama,Chris | meeting 02-08-22 | 100.00 |
| Nic Wenderoth | Public Hearing 02-03-22 | 100.00 |
| Puckett, Rick | Public Hearing 02-03-22 | 100.00 |
| Guadarrama,Chris | Public Hearing 02-03-22 | 100.00 |
| Lewis & Associates | 1099s | 70.00 |
| Lewis & Associates | bookkeeping | 500.00 |
| State Compensati... | 6120 wc insurance | 588.25 |

TOTAL

\$10,886.52

LEBEC COUNTY WATER DISTRICT

Profit & Loss Prev Year Comparison

February 2022

| | Feb 22 | Feb 21 | \$ Change | % Change |
|---|------------------|------------------|-----------------|----------------|
| Ordinary Income/Expense | | | | |
| Income | | | | |
| 4000 · Operating Revenue | | | | |
| 4010 · Commercial | 12,611.20 | 14,123.84 | -1,512.64 | -10.7% |
| 4040 · Residential | 13,478.88 | 13,172.28 | 306.60 | 2.3% |
| 4100 · Kern Co Tax Income | 1,250.17 | 922.81 | 327.36 | 35.5% |
| 4120 · Surplus Water | 2,756.25 | 551.25 | 2,205.00 | 400.0% |
| 4130 · Will Serve | 77.14 | 110.20 | -33.06 | -30.0% |
| 4140 · Late Charges & Customer Charg... | 1,546.51 | 1,473.62 | 72.89 | 5.0% |
| Total 4000 · Operating Revenue | 31,720.15 | 30,354.00 | 1,366.15 | 4.5% |
| Total Income | 31,720.15 | 30,354.00 | 1,366.15 | 4.5% |
| Expense | | | | |
| 6020 · Auto Expense | | | | |
| 6022 · Gas | 523.77 | 767.74 | -243.97 | -31.8% |
| 6028 · Repairs | | | | |
| 6028.1 · Chevy | 127.83 | 0.00 | 127.83 | 100.0% |
| Total 6028 · Repairs | 127.83 | 0.00 | 127.83 | 100.0% |
| 6030 · Service | | | | |
| 6030.1 · Dodge Service | 0.00 | 118.52 | -118.52 | -100.0% |
| 6030.2 · Chevy Service | 0.00 | 83.43 | -83.43 | -100.0% |
| Total 6030 · Service | 0.00 | 201.95 | -201.95 | -100.0% |
| Total 6020 · Auto Expense | 651.60 | 969.69 | -318.09 | -32.8% |
| 6040 · Bank Service Charge | 48.83 | 24.90 | 23.93 | 96.1% |
| 6050 · Compensation of Board | 500.00 | 500.00 | 0.00 | 0.0% |
| 6051 · GSA Compensation of Board | 200.00 | 100.00 | 100.00 | 100.0% |
| 6065 · Depreciation | 5,076.67 | 4,032.50 | 1,044.17 | 25.9% |
| 6070 · Dues & Subscriptions | 75.00 | 75.00 | 0.00 | 0.0% |
| 6081 · Emergency Communications | 44.72 | 44.56 | 0.16 | 0.4% |
| 6090 · Equipment Rental | 128.60 | 134.94 | -6.34 | -4.7% |
| 6110 · Insurance | | | | |
| 6112 · Insurance - AFLAC | 0.00 | 0.00 | 0.00 | 0.0% |
| 6113 · Medical Insurance | 2,623.70 | 2,548.68 | 75.02 | 2.9% |
| 6115 · Business Insurance | 1,737.08 | 788.67 | 948.41 | 120.3% |
| 6120 · Workers Compensation Insurance | 588.25 | 530.50 | 57.75 | 10.9% |
| Total 6110 · Insurance | 4,949.03 | 3,867.85 | 1,081.18 | 28.0% |
| 6130 · Maintenance | | | | |
| 6135 · Maintenance Services-System | 0.00 | 871.83 | -871.83 | -100.0% |
| 6140 · Maintenance Supplies | 237.24 | 0.00 | 237.24 | 100.0% |
| Total 6130 · Maintenance | 237.24 | 871.83 | -634.59 | -72.8% |
| 6155 · Office Expense | | | | |
| 6170 · Answering Service | 77.62 | 313.96 | -236.34 | -75.3% |
| 6175 · Office Repair | 110.37 | 510.37 | -400.00 | -78.4% |
| 6182 · Supplies-GSA | 1,163.25 | 0.00 | 1,163.25 | 100.0% |
| 6185 · Supplies | 102.37 | 123.05 | -20.68 | -16.8% |

LEBEC COUNTY WATER DISTRICT

Profit & Loss Prev Year Comparison

February 2022

| | Feb 22 | Feb 21 | \$ Change | % Change |
|--|------------------|------------------|------------------|---------------|
| Total 6155 · Office Expense | 1,453.61 | 947.38 | 506.23 | 53.4% |
| 6190 · Operating Supplies | 460.65 | 0.00 | 460.65 | 100.0% |
| 6215 · Payroll - Gross Wages | 15,255.03 | 15,823.68 | -568.65 | -3.6% |
| 6235 · Payroll Service Fees | 6.00 | 6.00 | 0.00 | 0.0% |
| 6245 · Postage | 0.00 | 64.19 | -64.19 | -100.0% |
| 6250 · Professional Fees | | | | |
| 6255 · Accounting / Bookkeeping | 570.00 | 500.00 | 70.00 | 14.0% |
| Total 6250 · Professional Fees | 570.00 | 500.00 | 70.00 | 14.0% |
| 6290 · Rent | 1,000.00 | 1,000.00 | 0.00 | 0.0% |
| 6310 · Software System | 0.00 | 296.92 | -296.92 | -100.0% |
| 6315 · Taxes | | | | |
| 6320 · Payroll Taxes | 1,458.32 | 1,541.59 | -83.27 | -5.4% |
| Total 6315 · Taxes | 1,458.32 | 1,541.59 | -83.27 | -5.4% |
| 6340 · Telephone | 215.11 | 458.30 | -243.19 | -53.1% |
| 6355 · Utilities - Office | | | | |
| 6360 · Electric | 48.65 | 0.00 | 48.65 | 100.0% |
| 6365 · Gas | 166.36 | 102.27 | 64.09 | 62.7% |
| 6370 · Trash | 0.00 | 129.32 | -129.32 | -100.0% |
| Total 6355 · Utilities - Office | 215.01 | 231.59 | -16.58 | -7.2% |
| 6375 · Utilities - Pumps | | | | |
| 6380 · Electric | 3,507.38 | 6,591.55 | -3,084.17 | -46.8% |
| Total 6375 · Utilities - Pumps | 3,507.38 | 6,591.55 | -3,084.17 | -46.8% |
| 6390 · Water Test | 125.00 | 62.50 | 62.50 | 100.0% |
| Total Expense | 36,177.80 | 38,144.97 | -1,967.17 | -5.2% |
| Net Ordinary Income | -4,457.65 | -7,790.97 | 3,333.32 | 42.8% |
| Net Income | -4,457.65 | -7,790.97 | 3,333.32 | 42.8% |

LEBEC COUNTY WATER DISTRICT

Profit & Loss Prev Year Comparison

July 2021 through February 2022

| | Jul '21 - Feb... | Jul '20 - Feb... | \$ Change | % Change |
|---|-------------------|-------------------|------------------|---------------|
| Ordinary Income/Expense | | | | |
| Income | | | | |
| 4000 · Operating Revenue | | | | |
| 4010 · Commercial | 133,964.48 | 129,063.25 | 4,901.23 | 3.8% |
| 4040 · Residential | 127,726.96 | 128,332.14 | -605.18 | -0.5% |
| 4100 · Kern Co Tax Income | 32,080.70 | 30,998.12 | 1,082.58 | 3.5% |
| 4120 · Surplus Water | 38,287.34 | 8,709.77 | 29,577.57 | 339.6% |
| 4130 · Will Serve | 661.20 | 892.62 | -231.42 | -25.9% |
| 4140 · Late Charges & Customer Charg... | 8,620.90 | 7,328.46 | 1,292.44 | 17.6% |
| Total 4000 · Operating Revenue | 341,341.58 | 305,324.36 | 36,017.22 | 11.8% |
| Total Income | 341,341.58 | 305,324.36 | 36,017.22 | 11.8% |
| Expense | | | | |
| 6010 · Advertising | 0.00 | 79.20 | -79.20 | -100.0% |
| 6020 · Auto Expense | | | | |
| 6022 · Gas | 8,330.89 | 3,618.66 | 4,712.23 | 130.2% |
| 6028 · Repairs | | | | |
| 6028.1 · Chevy | 226.56 | 1,305.05 | -1,078.49 | -82.6% |
| 6028.2 · DODGE | 1,556.61 | 295.86 | 1,260.75 | 426.1% |
| 6028.4 · GENERATOR | 4,716.86 | 0.00 | 4,716.86 | 100.0% |
| Total 6028 · Repairs | 6,500.03 | 1,600.91 | 4,899.12 | 306.0% |
| 6030 · Service | | | | |
| 6030.1 · Dodge Service | 358.99 | 321.44 | 37.55 | 11.7% |
| 6030.2 · Chevy Service | 671.23 | 250.29 | 420.94 | 168.2% |
| Total 6030 · Service | 1,030.22 | 571.73 | 458.49 | 80.2% |
| Total 6020 · Auto Expense | 15,861.14 | 5,791.30 | 10,069.84 | 173.9% |
| 6040 · Bank Service Charge | 478.25 | 212.89 | 265.36 | 124.7% |
| 6050 · Compensation of Board | 2,600.00 | 3,200.00 | -600.00 | -18.8% |
| 6051 · GSA Compensation of Board | 900.00 | 300.00 | 600.00 | 200.0% |
| 6060 · Contracted Maintenance Services | 3,385.20 | 22,396.32 | -19,011.12 | -84.9% |
| 6065 · Depreciation | 40,613.36 | 32,260.00 | 8,353.36 | 25.9% |
| 6070 · Dues & Subscriptions | 4,257.00 | 2,377.00 | 1,880.00 | 79.1% |
| 6075 · Education | 260.00 | 0.00 | 260.00 | 100.0% |
| 6081 · Emergency Communications | 356.64 | 253.43 | 103.21 | 40.7% |
| 6090 · Equipment Rental | 1,001.02 | 14,798.87 | -13,797.85 | -93.2% |
| 6095 · Fees and Permits | 1,029.34 | 2,917.00 | -1,887.66 | -64.7% |
| 6105 · Interest | 41.17 | 18.64 | 22.53 | 120.9% |
| 6110 · Insurance | | | | |
| 6112 · Insurance - AFLAC | 0.00 | 0.00 | 0.00 | 0.0% |
| 6113 · Medical Insurance | 21,709.68 | 22,616.12 | -906.44 | -4.0% |
| 6115 · Business Insurance | 7,950.19 | 5,520.69 | 2,429.50 | 44.0% |
| 6120 · Workers Compensation Insurance | 5,218.00 | 3,042.79 | 2,175.21 | 71.5% |
| Total 6110 · Insurance | 34,877.87 | 31,179.60 | 3,698.27 | 11.9% |
| 6130 · Maintenance | | | | |
| 6135 · Maintenance Services-System | 1,921.45 | 5,457.77 | -3,536.32 | -64.8% |
| 6140 · Maintenance Supplies | 5,245.41 | 2,051.20 | 3,194.21 | 155.7% |

LEBEC COUNTY WATER DISTRICT

03/03/22

Profit & Loss Prev Year Comparison

Accrual Basis

July 2021 through February 2022

| | Jul '21 - Feb... | Jul '20 - Feb... | \$ Change | % Change |
|--|-------------------|-------------------|-------------------|---------------|
| Total 6130 · Maintenance | 7,166.86 | 7,508.97 | -342.11 | -4.6% |
| 6155 · Office Expense | | | | |
| 6160 · Computer | 220.00 | 249.89 | -29.89 | -12.0% |
| 6170 · Answering Service | 579.09 | 649.98 | -70.89 | -10.9% |
| 6175 · Office Repair | 2,104.77 | 1,688.17 | 416.60 | 24.7% |
| 6182 · Supplies-GSA | 1,163.25 | 214.16 | 949.09 | 443.2% |
| 6185 · Supplies | 1,924.16 | 2,158.39 | -234.23 | -10.9% |
| Total 6155 · Office Expense | 5,991.27 | 4,960.59 | 1,030.68 | 20.8% |
| 6190 · Operating Supplies | 460.65 | 0.00 | 460.65 | 100.0% |
| 6205 · Outside Services | 468.00 | 0.00 | 468.00 | 100.0% |
| 6215 · Payroll - Gross Wages | 116,869.99 | 129,257.43 | -12,387.44 | -9.6% |
| 6233 · Employee Drug Testing Fees | 0.00 | 125.00 | -125.00 | -100.0% |
| 6235 · Payroll Service Fees | 48.00 | 42.00 | 6.00 | 14.3% |
| 6245 · Postage | 1,627.56 | 1,627.42 | 0.14 | 0.0% |
| 6250 · Professional Fees | | | | |
| 6255 · Accounting / Bookkeeping | 4,200.00 | 4,010.00 | 190.00 | 4.7% |
| 6260 · Audit | 16,300.00 | 17,500.00 | -1,200.00 | -6.9% |
| Total 6250 · Professional Fees | 20,500.00 | 21,510.00 | -1,010.00 | -4.7% |
| 6290 · Rent | 8,000.00 | 8,000.00 | 0.00 | 0.0% |
| 6310 · Software System | 2,378.39 | 1,481.75 | 896.64 | 60.5% |
| 6315 · Taxes | | | | |
| 6320 · Payroll Taxes | 11,104.14 | 11,471.38 | -367.24 | -3.2% |
| 6325 · Property Tax | 115.15 | 113.52 | 1.63 | 1.4% |
| Total 6315 · Taxes | 11,219.29 | 11,584.90 | -365.61 | -3.2% |
| 6340 · Telephone | 3,239.41 | 3,677.91 | -438.50 | -11.9% |
| 6342 · Tools | 0.00 | 1,023.89 | -1,023.89 | -100.0% |
| 6355 · Utilities - Office | | | | |
| 6360 · Electric | 659.24 | 667.16 | -7.92 | -1.2% |
| 6365 · Gas | 358.67 | 261.92 | 96.75 | 36.9% |
| 6370 · Trash | 414.66 | 535.78 | -121.12 | -22.6% |
| Total 6355 · Utilities - Office | 1,432.57 | 1,464.86 | -32.29 | -2.2% |
| 6375 · Utilities - Pumps | | | | |
| 6380 · Electric | 38,530.26 | 33,161.99 | 5,368.27 | 16.2% |
| Total 6375 · Utilities - Pumps | 38,530.26 | 33,161.99 | 5,368.27 | 16.2% |
| 6390 · Water Test | 1,487.50 | 1,970.00 | -482.50 | -24.5% |
| Total Expense | 325,080.74 | 343,180.96 | -18,100.22 | -5.3% |
| Net Ordinary Income | 16,260.84 | -37,856.60 | 54,117.44 | 143.0% |
| Other Income/Expense | | | | |
| Other Income | | | | |
| 9000 · Interest Income | 28.85 | 46.88 | -18.03 | -38.5% |
| 9010 · Gain/Loss on Asset | 1,000.00 | 0.00 | 1,000.00 | 100.0% |
| 9012 · Donations Revenue | 151,564.23 | 0.00 | 151,564.23 | 100.0% |

LEBEC COUNTY WATER DISTRICT
Profit & Loss Prev Year Comparison

July 2021 through February 2022

| | Jul '21 - Feb... | Jul '20 - Feb... | \$ Change | % Change |
|-----------------------------|-------------------|-------------------|-------------------|-----------------|
| 9015 · Grant Income | 0.00 | -5,118.48 | 5,118.48 | 100.0% |
| Total Other Income | 152,593.08 | -5,071.60 | 157,664.68 | 3,108.8% |
| Other Expense | | | | |
| 9016 · Grant Expense | 0.00 | 0.00 | 0.00 | 0.0% |
| Total Other Expense | 0.00 | 0.00 | 0.00 | 0.0% |
| Net Other Income | 152,593.08 | -5,071.60 | 157,664.68 | 3,108.8% |
| Net Income | 168,853.92 | -42,928.20 | 211,782.12 | 493.3% |

Lebec County Water District

Monthly Distribution Report

February 2022

| State Well | February | January | Well Draw-down | Uranium | Fluoride | Nitrate |
|-----------------------------------|-----------------|-----------|--------------------|-------------------------|-------------------|------------------|
| Static Level | 131.5 FT | 131.9 FT | Dec. 1.6 FT | pCi/L 13.2 / 20 | mg/L 1.8 / 2.0 | mg/L 6.0 / 10 |
| Pumping level | 133.1 FT | 133.3 FT | Nov. 1.4 FT | | | |
| GPM(Average) | 49.38 GMP | 59.15 GPM | 0.2 FT | Hours | | |
| Monthly Water Production | 2,133,221 | 2,555,093 | Date Time | Bacteriological: | | |
| | | | Static 03-03 13:34 | 176 | Absent | |
| | | | Draw 03-03 14:39 | | | |
| Water production Variance: | -421,872 | | | | | |

| Lebec Well | February | January | Well Draw-down | Uranium | Fluoride | Nitrate |
|-----------------------------------|----------------|-----------|--------------------|-------------------------|-------------------|------------------|
| Static Level | 93.2 FT | 93.5 FT | Dec. 9.2 FT | pCi/L 4.8 / 20 | mg/L 1.2 / 2.0 | mg/L 5.3 / 10 |
| Pumping level | 102.4 FT | 102.8 FT | Nov. 9.3 FT | | | |
| GPM(Average) | 30.08 GMP | 25.20 GPM | -0.1 FT | Hours | | |
| Monthly Water Production | 1,299,605 | 1,088,751 | Date Time | Bacteriological: | | |
| | | | Static 03-03 13:46 | 118 | Absent | |
| | | | Draw 03-03 14:51 | | | |
| Water production Variance: | 210,854 | | | | | |

| Chimney Canyon Well | February | January | Well Draw-down | Uranium | Fluoride | Nitrate |
|-----------------------------------|----------------|-----------|--------------------|-------------------------|-------------------|------------------|
| Static Level | 174.6 FT | 174.9 FT | Dec. 20.3 FT | pCi/L 8.9 / 20 | mg/L 2.1 / 2.0 | mg/L 6.6 / 10 |
| Pumping level | 194.9 FT | 195.3 FT | Nov. 20.4 FT | | | |
| GPM(Average) | 23.49 GMP | 19.53 GPM | -0.1 FT | Hours | | |
| Monthly Water Production | 1,014,617 | 843,707 | Date Time | Bacteriological: | | |
| | | | Static 03-03 14:15 | 177 | Absent | |
| | | | Draw 03-03 15:12 | | | |
| Water production Variance: | 170,910 | | | | | |

| Cuddy Creek Surplus | February | January |
|-----------------------------------|-----------------|---------|
| Monthly Water Production | 8,305 | 574,696 |
| Water production Variance: | -566,391 | |

| Monthly Total | February | January | Total Water loss |
|----------------------------|-------------------|----------------|---------------------------|
| Water Pumped | 4,455,748 | 4,487,551 | Gallons -1,938,003 |
| Water Sold | 2,618,179 | 4,587,985 | Percent. 41.24% |
| Water Loss Variance | -1,837,569 | 100,434 | |

| Generator Log | | |
|---|----------|--------|
| Generator | Run-time | ODO |
| 55KW(A) | NA | 25H15M |
| 55KW(B) | NA | 27H21M |
| 80KW | NA | 25H20M |
| 100KW | NA | 18771 |
| Generator Comments | | |
| Still waiting on fuses from PTS for 100KW | | |
| | | |
| | | |
| | | |

Lebec County Water District

Monthly Distribution Report

Monthly Water System Updates

February 2022

- 1) Bac-T came back absent

- 2) state well booster tank was cleaned and tested still awaiting results

- 3) valves for chimney tank 3 and tank 7 have failed and need to be replaced currently working on getting a quote

All other systems are functioning as they should, Thank You!

By: Daniel Garcia

Fire Service Meter with Bypass Sizes 3", 4", 6", 8", 10"

Features

APPLICATIONS: The Hersey® Meters FM³ fire service meter is designed for combined fire service and domestic water where a single supply line supports both fire and domestic or process needs. The meter may be utilized in automatic sprinkler systems and fire service, as a master meter for an entire water system, as a master meter for zoned systems, and for domestic or processed water where accuracy across a broad range of flows is critical. The FM³ meter eliminates the need for secondary service lines, saving time and reducing installation expenses and is compliant for all UL®, FM®, NSF®-61 fire service meter applications.

CONSTRUCTION: Every Hersey FM³ meter is manufactured with epoxy coated ductile iron construction which eliminates additional gaskets and fasteners, reducing ongoing maintenance costs. The unique, Hersey strainer design protects the horizontal turbine meter measuring element in a unibody construction that reduces meter vault and installation costs due to its compact size and reduced weight while providing four times the inlet pipe diameter of strainer surface area. The unitized horizontal turbine measuring element is easily accessed through the top case of the meter and o-ring seals simplify field service. A Hersey EDCIV™ detector check provides proven backflow protection with a spring loaded clapper assembly that is mounted to the top case of the check valve for ease of service. Bypasses consist of an appropriately sized positive displacement or residential fire line meter for low flow accuracy. Dual ball valves permit isolation of the meter and a swing check prevents backflow through the bypass. Stainless steel and bronze fasteners are used throughout the meter where required.

REGISTER: Separate mainline and bypass registers provide visibility of performance and field testing opportunity. The permanently sealed registers use proven magnetic drive design and the exclusive Hersey triple seal provides clarity and error free meter reading. Internal gears are self lubricating, molded plastic for minimal friction and a long service life. Standard visual read and electronic Translator® registers offer odometer wheels with a totalizing display, 360° degree test circle with center sweep hand and a low flow indicator. All Hersey FM³ models are available with electronic meter reading system components to meet any utility AMR/AMI requirement and all registers are protected by the unique Hersey locking pin which requires no special removal tools for field service.

OPERATION: During normal low flow operation, all water flows through the sensitive bypass meter for accurate registration. As flow and pressure loss through the bypass increases, the mainline clapper assembly automatically opens, permitting water to flow through the horizontal turbine measuring element and the bypass meter for accurate combined registration of all flows. The element employs Hersey's unique Retro-Thrust® feature to divide wear across multiple points, increasing accuracy, reducing friction and extending the life of the measuring element. Integral flow straightening vanes on the inlet and outlet sides of the measuring element contribute to the long term accuracy of the meter. As flow and pressure loss through the bypass meter decrease, the clapper assembly once again closes, redirecting all water through the bypass. Higher demand instances include master meter supply applications and fire suppression requirements.

INSTALLATION: Hersey FM³ meters are designed for horizontal installation with a minimum of five times the inlet pipe diameter of straight pipe prior to the meter and a minimum of three times the pipe diameter after the meter.

MAINTENANCE: All service components for the FM³ are unitized for easy replacement. Access to components is accomplished through the top side of the meter for full in-line service. Drop In Measuring Elements (DIMES) are available in pre-tested configurations which include a new measuring element, top case, register and o-ring for utilities that require quick field replacement. A calibration vane permits field adjustments to ensure accurate registration and extend the service life of the measuring element. The calibration vane is protected by the register and the locking pin for added security. For additional information regarding Hersey's unitized replacement options, please contact the Mueller Systems Sales and Technical Support Group at 800-323-8584.

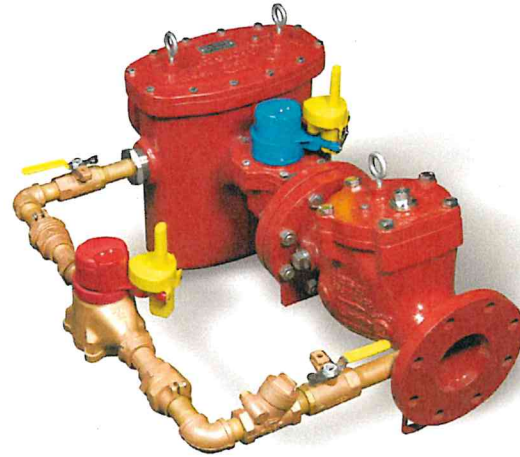

4" x 1" FM³ with Residential Fire Meter

FM³ with Bypass

Materials and Specifications

| | |
|--------------------------|---|
| MODEL | FM ³ Fire Service Meter |
| SIZES | 3" with 3/4" RFM bypass meter 4" with 1" RFM bypass meter 6" with 2" PD bypass meter 8" with 2" PD bypass meter 10" with 2" PD bypass meter |
| STANDARDS | Manufactured and tested to meet or exceed all applicable parts of AWWA C703, NSF®-61 compliant |
| INSTALLATION | Horizontal only with 5X pipe diameter of straight pipe (same size as meter) on inlet and 3X on outlet side of meter |
| OPERATING FLOW RANGE | See Chart on the following page |
| ACCURACY | See Chart on the following page |
| PRESSURE LOSS | See Chart on the following page |
| MAXIMUM WORKING PRESSURE | 175 PSI |
| WATER TEMPERATURE RANGE | 33°F to 100°F |
| MEASURING ELEMENT | Mainline: Horizontal Turbine Element on all sizes Bypass: RFM.....Vertical Turbine Residential Fire Meter on 3" and 4" sizes Bypass: PD.....High Pressure Nutating Disc Meter on 6", 8" and 10" sizes |
| METER CONNECTIONS | ANSI class 125 standard end flanges |
| OPTIONS | All AMR/AMI Reading Systems |

Fire Service Meter with Bypass Sizes 3", 4", 6", 8", 10"

FM³ with Bypass

Meter Registration

| Meter Size | Initial Dial* | Capacity | Initial Dial* | Capacity |
|------------|---------------|-------------|----------------|-------------|
| 3" | 100 Gallons | 100 Million | 10 Cubic Feet | 10 Million |
| 4" | 100 Gallons | 100 Million | 10 Cubic Feet | 10 Million |
| 6" | 1000 Gallons | 1 Billion | 100 Cubic Feet | 100 Million |
| 8" | 1000 Gallons | 1 Billion | 100 Cubic Feet | 100 Million |
| 10" | 1000 Gallons | 1 Billion | 100 Cubic Feet | 100 Million |

*Registration equal to one full revolution of the sweep hand.

Flow Characteristics

| Meter Size | Typical Low Flow (95% Min) | Typical Operating Range (100% ± 1.5%) | Maximum Continuous Operation | Maximum Intermittent Flow |
|------------|----------------------------|---------------------------------------|------------------------------|---------------------------|
| 3" | 1/2 GPM | 6 to 600 GPM | 600 GPM | 750 GPM |
| 4" | 3/4 GPM | 8 to 1000 GPM | 1000 GPM | 1250 GPM |
| 6" | 2 GPM | 15 to 2000 GPM | 2000 GPM | 2600 GPM |
| 8" | 2 GPM | 30 to 3500 GPM | 3500 GPM | 4400 GPM |
| 10" | 2 GPM | 40 to 5500 GPM | 5500 GPM | 7000 GPM |

Dimensions and Weights

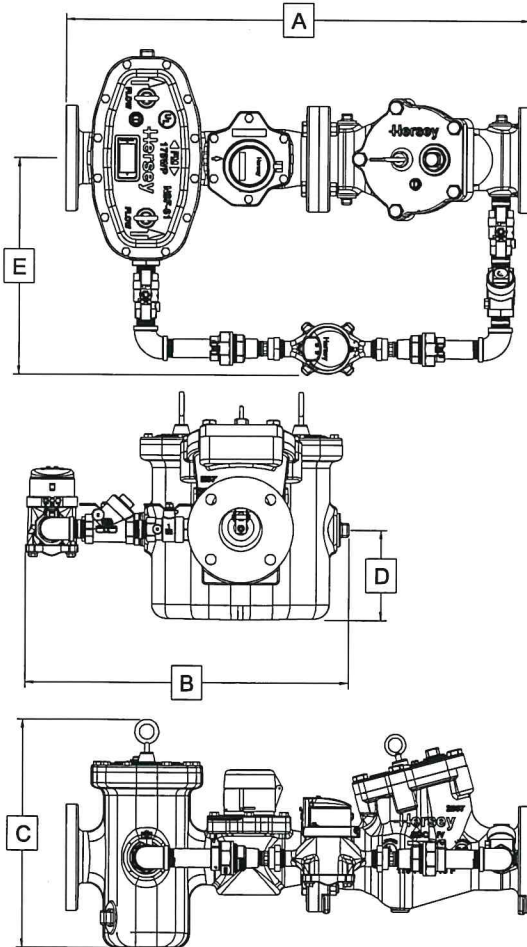

| Meter Size | 3x3/4 | 4x1 | 6x2 | 8x2 | 10x2 |
|------------------|---------|---------|-----------|-----------|-----------|
| Dimension | | | | | |
| A | 33" | 35" | 45" | 53" | 68" |
| B | 23-5/8" | 23-5/8" | 33-11/32" | 33" | 39-17/32" |
| C | 16" | 19" | 24-1/4" | 25-15/16" | 31-7/16" |
| D | 6-3/8" | 9-3/8" | 11-1/2" | 11-9/16" | 14" |
| E | 15-5/8" | 15-5/8" | 22-11/32" | 19-7/8" | 22-29/32" |
| Weight | 220 | 250 | 590 | 890 | 1550 |

NOTE: Weights are in pounds and are approximate.

Performance

Head Loss – 3" with 3/4" RFM Bypass

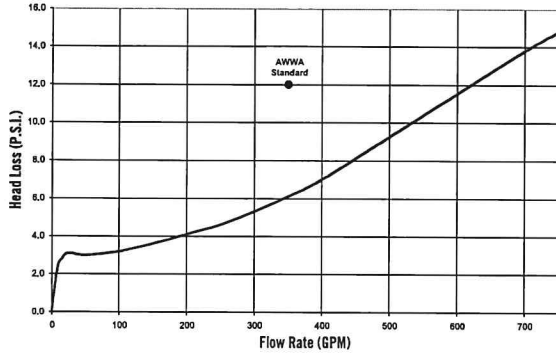

Performance

Head Loss – 4" with 1" RFM Bypass

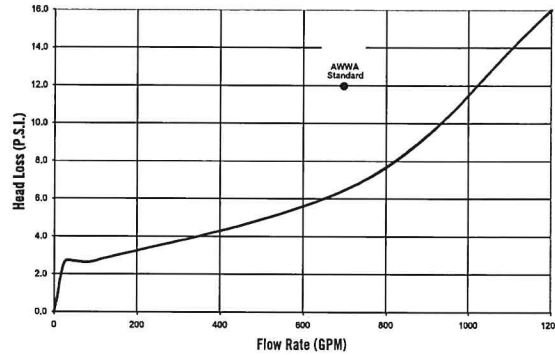

Accuracy – 3" with 3/4" RFM Bypass

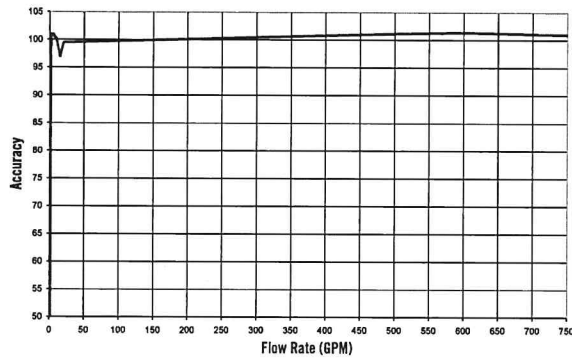

Accuracy – 4" with 1" RFM Bypass

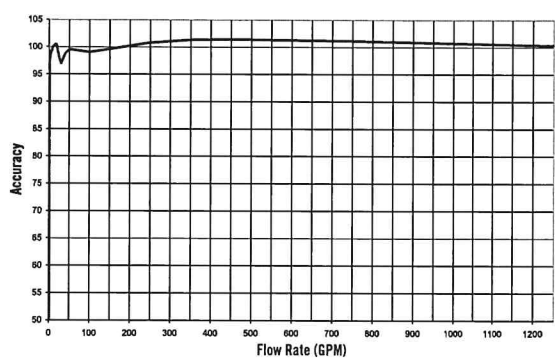

NOTE: Performance curves are typical only and NOT a guarantee of performance.

NOTE: Performance curves are typical only and NOT a guarantee of performance.

Head Loss – 6" with 2" PD Bypass

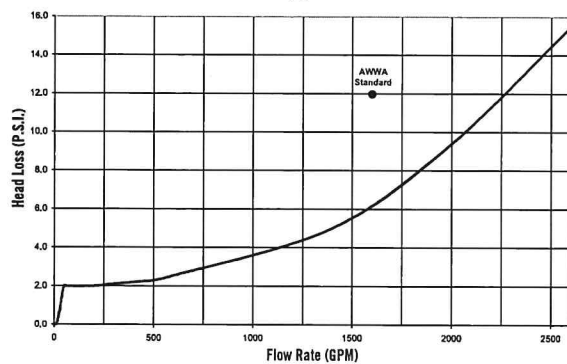

Head Loss – 8" with 2" PD Bypass

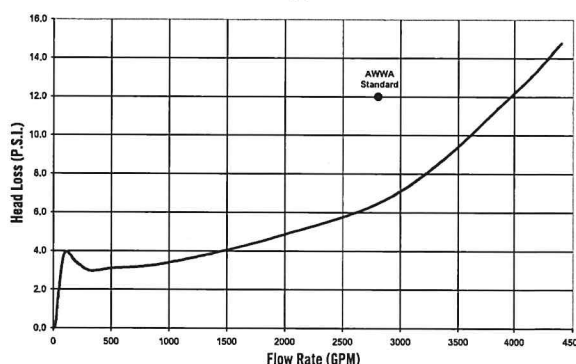

Performance

Accuracy – 6" with 2" PD Bypass

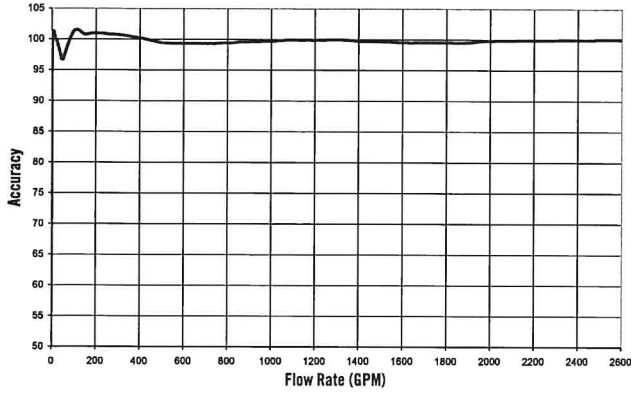

NOTE: Performance curves are typical only and NOT a guarantee of performance.

Performance

Accuracy – 8" with 2" PD Bypass

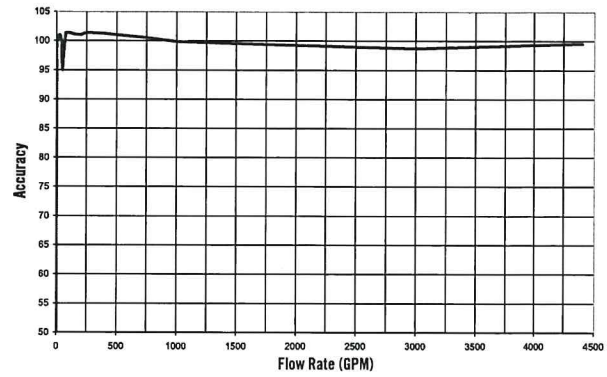

NOTE: Performance curves are typical only and NOT a guarantee of performance.

Head Loss – 10 with 2" PD Bypass Meter

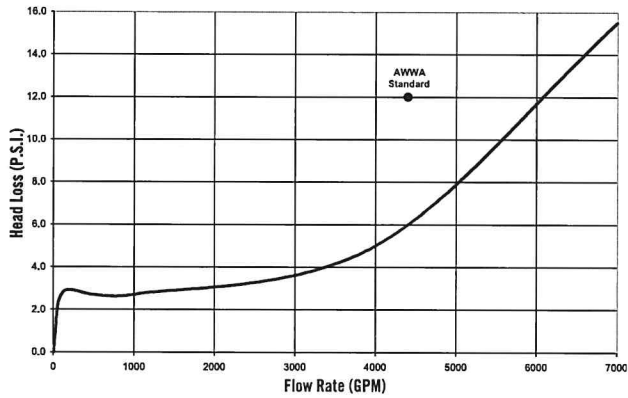

NOTE: Performance curves are typical only and NOT a guarantee of performance.

Accuracy – 10" with 2" PD Bypass Meter

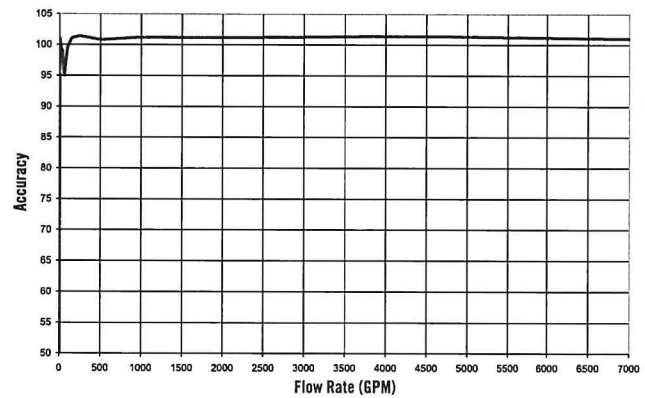

NOTE: Performance curves are typical only and NOT a guarantee of performance.

FM³

Fire Service Meter with Bypass
Sizes 3", 4", 6", 8", 10"



FM3 WITH BYPASS EXPLODED ASSEMBLY (See parts listing, next page)

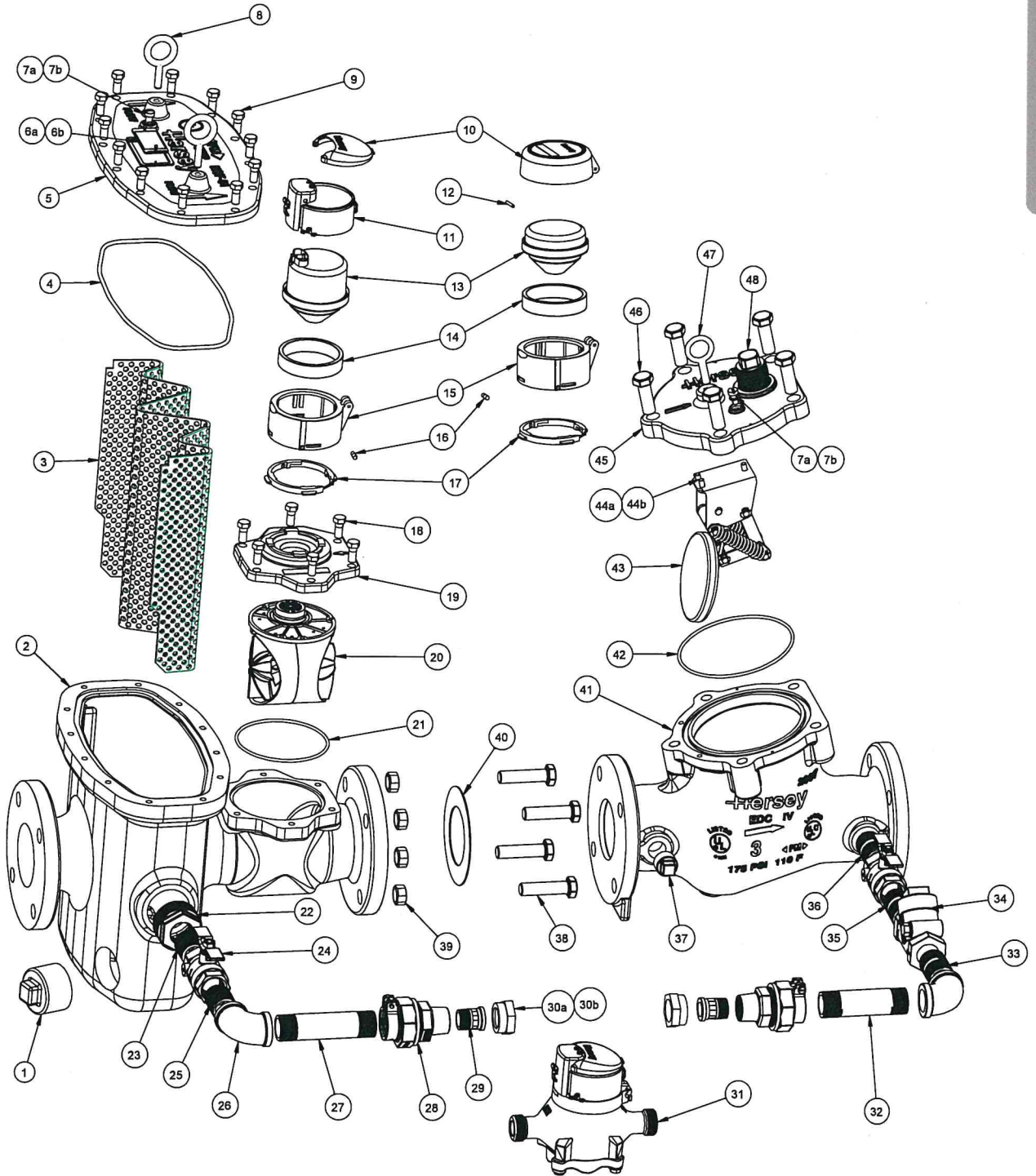

FM³ with Bypass

Fire Service Meter with Bypass Sizes 3", 4", 6", 8", 10"

3" - 10" FM3 WITH BYPASS PARTS LIST (See exploded assembly diagram for reference)

FM³ with Bypass

| # | DESCRIPTION | 3" x 3/4" with RFM | 4" x 1" with RFM | 6" x 2" with HP PD | 8" x 2" with HP PD | 10" x 2" with HP PD |
|-----|---|----------------------------|----------------------------|----------------------------|----------------------------|----------------------------|
| 1 | TEST PORT PLUG | 59010PLA (3) | 59010PLA (3) | 59010PLA (3) | 59010PLA (3) | 59010PLA (3) |
| 2 | FM3 BODY | D3624 | D3603 | D3608 | D3614 | D3618 |
| 3 | STRAINER SCREEN | B8634 | C6628 | C6615 | C6614 | C6616 |
| 4 | STRAINER COVER O-RING | A13077 | A13077 | A13078 | A13079 | A13080 |
| 5 | STRAINER COVER | C6620 | C6620 | D3616 | D3610 | D3620 |
| 6a | NAME TAG | A13054 | A13054 | A13054 | A13054 | A13054 |
| 6b | DRIVE SCREW | 7199070109 | 7199070109 | 7199070109 | 7199070109 (2) | 7199070109 (2) |
| 7a | VENT SCREW | 59003 | 59003 | 59003 | 59003 | 59003 |
| 7b | VENT SCREW WASHER | 59073 | 59073 | 59073 | 59073 | 59073 |
| 8 | EYE BOLT | AS7733 (2) | AS7733 (2) | AS7731 (2) | AS7732 (2) | AS7732 (2) |
| 9 | STRAINER COVER BOLT | 90065 (12) | 90065 (12) | 90180 (20) | 90243 (20) | 90264 (24) |
| 10 | TRANSLATOR LID VISUAL READ LID | B8638 50381 | B8638 50381 | B8638 50381 | B8638 50381 | B8638 50381 |
| 11 | WIRE EXIT HOUSING | C6624 | C6624 | C6624 | C6624 | C6624 |
| 12 | LID HINGE PIN | AS41122 | AS41122 | AS41122 | AS41122 | AS41122 |
| 13 | TRANSLATOR REGISTER VISUAL READ REGISTER | D3655XXXX D3663X | D3656XXXX D3663X | D3657XXXX D3663X | D3658XXXX D3663X | D3659XXXX D3663X |
| 14 | REGISTER SPACER | 50382 | 50382 | 50382 | 50382 | 50382 |
| 15 | TRANSLATOR HOUSING BASE VISUAL READ HOUSING BASE | C6637 50380 | C6637 50380 | C6637 50380 | C6637 50380 | C6637 50380 |
| 16 | LOCKING PIN | A12658 | A12658 | A12658 | A12658 | A12658 |
| 17 | REGISTER HOUSING INSERT | C5770 | C5770 | C5770 | C5770 | C5770 |
| 18 | ELEMENT COVER BOLT | 90065 (6) | 90065 (6) | 90264 (8) | 90264 (8) | 90264 (8) |
| 19 | ELEMENT COVER | C6618 | C6618 | C6612 | C6612 | C6630 |
| 20 | MEASURING ELEMENT | C6598 | C6598 | 54700 | 54700 | 54700 |
| 21 | ELEMENT COVER O-RING | 54602 | 54602 | B8657 | B8657 | B8636 |
| 22 | REDUCING BUSHING | 96049NSF | 96049NSF | N/A | N/A | N/A |
| 23 | NIPPLE | 96062 | 96063 | 9605J | 9605J | 9605J |
| 24 | LOCKING BALL VALVE | 96551 (2) | 96551 (2) | 96553 (2) | 96553 (2) | 96553 (2) |
| 25 | NIPPLE | 9605G | 9605G | 9605J | 9605J | 9607G |
| 26 | 90° ELBOW | 96037SS (2) | 96037SS (2) | 96039 (2) | 96039 (2) | 96039 (2) |
| 27 | CUT NIPPLE | 96062 | 96063 | 96173 | 96174 | 96072 |
| 28 | PACK JOINT | 96010 (2) | 96011 (2) | 96012 (2) | 96012 (2) | 96012 (2) |
| 29 | CONNECTION TAILPIECE | 96033 (2) | 95062 (2) | N/A | N/A | N/A |
| 30a | CONNECTION NUT | 95033 (2) | 95058 (2) | N/A | N/A | N/A |
| 30b | CONNECTION WASHER | 95038 (2) | 95057 (2) | N/A | N/A | N/A |
| 31 | BYPASS METER | SEE RFM SHEET | SEE RFM SHEET | SEE HP PD SHEET | SEE HP PD SHEET | SEE HP PD SHEET |
| 32 | CUT NIPPLE | 96062 | 96063 | 96173 | 96174 | 96072 |
| 33 | NIPPLE | 9605G | 9605G | 9605J | 9605J | 9609H |
| 34 | SWING CHECK VALVE | 96092 | 96092 | 96094 | 96094 | 96094 |
| 35 | NIPPLE | 9606F | 9606F | 9605J | 9605J | 9608C |
| 36 | NIPPLE | 9614A | 9614A | 96138 | 9619B | 9617C |
| 37 | TEST PORT PLUG | 59013 (3) | 59013 (3) | 59010PLA (3) | 59010PLA (3) | 59010PLA (3) |
| 38 | FLANGE CONNECTION BOLT | 90256 (4) | 90256 (6) | 90308 (8) | 90311 (8) | 90365 (12) |
| 39 | FLANGE CONNECTION NUT | AS7633 (4) | AS7633 (8) | 90335 (8) | 90339 (8) | 90356 (12) |
| 40 | FLANGE CONNECTION GASKET | 923701011NSF | 923701014NSF | 923701015NSF | 923701016NSF | 923701017NSF |
| 41 | F x F EDCIV BODY | E20841 | E200531 | E20154 | E20094 | E20214 |
| 42 | EDCIV COVER O-RING | AS7612 | AS7612 | AS7613 | AS7614 | AS7615 |
| 43 | CLAPPER ASSEMBLY | E20843 | E20843 | E20153 | E20093 | E20213 |
| 44a | CLAPPER BRACKET BOLT | AS7621 (3) | AS7621 (3) | AS7622 (3) | AS7623 (3) | AS7623 (3) |
| 44b | CLAPPER BRACKET LOCK WASHER | AS7651 (3) | AS7651 (3) | AS7653 (3) | AS7654 (3) | AS7654 (3) |
| 45 | EDCIV COVER | D3626 | D3626 | D3628 | D3630 | D3632 |
| 46 | EDCIV COVER BOLT | 90241 (5) | 90241 (5) | 90264 (8) | AS48227SS (8) | AS48229SS (8) |
| 47 | EYE BOLT | AS7733 | AS7733 | AS7731 | AS7731 (2) | AS7731 (2) |
| 48 | TEST PORT PLUG | 59027NSF | 59027NSF | 59009NSF | 59009NSF | 59009NSF |
| 49 | D.I.M.E. Includes #'s (10-17) & (19-21) | CALL M.S. CUSTOMER CARE | CALL M.S. CUSTOMER CARE | CALL M.S. CUSTOMER CARE | CALL M.S. CUSTOMER CARE | CALL M.S. CUSTOMER CARE |